

LEGION

LIGHTBAR

User Manual

Pre-Installation

Wiring & Functions

Vehicle Roof Installation

Standard Feet

Adjustable Feet

- Permanent Mount
- Strap Kit Mount

Flat Surf Installation

Narrow Surface Mount

Wide Surface Mount



PRE-INSTALLATION

To prevent damage to lightbar and vehicle, ensure that all equipment operates properly, and carefully plan where to mount and wire the lightbar and controlling equipment:

1. Verify that the lightbar and mounting hardware fit the vehicle.
2. Pre-configure desired lightbar functions.
3. Determine:
 - the location to mount the lightbar.
 - the location to route the lightbar's Power Cable.
 - the location to route the Function Cable, (eg. to siren, switch box, console).

WARNING: Take extreme care when routing wires around airbag areas to not interfere with it's proper operation.

4. Separate all electronic equipment wiring from two-way radio equipment wiring.
5. To avoid interference, keep two-way radio antennas a minimum of 50cm away from warning equipment.
6. After drilling holes, deburr and smooth sharp edges, and insert grommets to protect the wires from chafing.
7. When frame-ground the equipment, use the manufacturer-supplied ground locations in the vehicle.

WIRING & FUNCTIONS

Different applications require different functions. It is highly recommended to determine and configure the required functions prior to Installation; (refer to 'CONTROL CABLE' section).

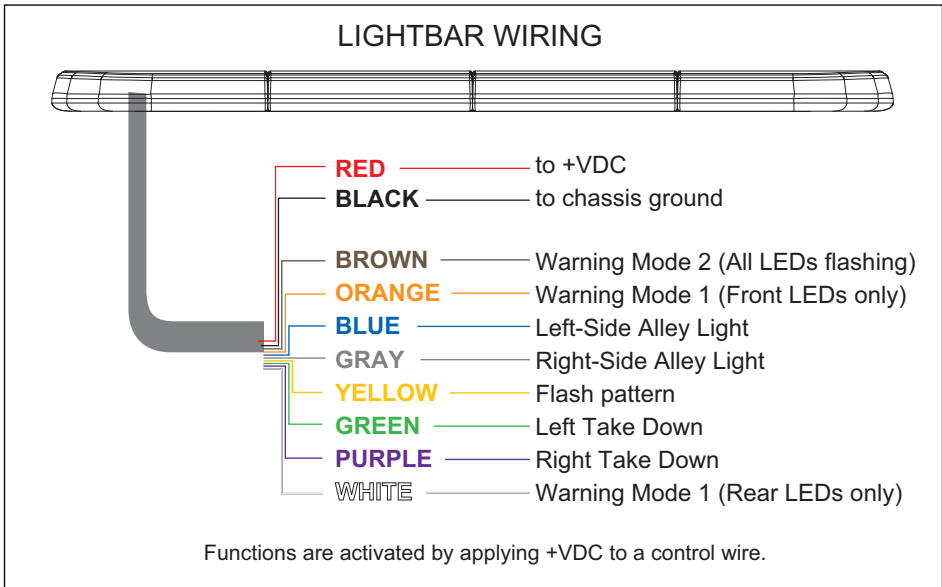

POWER WIRES

1. Route Power Cable to the vehicle firewall towards the battery.
2. Follow factory wiring harness through the firewall. It may be necessary to drill a hole in the firewall. Ensure that there are no components that could be damaged from the drilling.
3. Route the cable to the battery.
4. Install a 20Amp fuse (user-supplied) on the end of **RED** wire, then connect to battery.
5. Connect **BLACK** wire to the factory chassis ground adjacent to the battery.

NOTE: make sure that all wires of power cable are securely connected to power source.

CONTROL WIRES

1. Route Control wires towards the dash area to a switch panel (user-supplied).
2. Connect the required wires to the switch panel.

LIGHTBAR ACTIVATION

The Lightbar can be activated in different Warning Modes. Apply **+12VDC** to:

- **WHITE** wire to activate Warning Mode 1 Rear only.
- **ORANGE** wire to activate Warning Mode 1 Front only.
- **BROWN** wire to activate Warning Mode 2 (Front & Rear).

NOTE: In Mode 2, flashing Take Downs and Alleys are automatically activated.

LIGHTBAR FLASH PATTERNS

Flash Pattern can be selected from FLASH PATTERNS chart. Activate the desired mode, and momentarily tap **+12VDC** to **YELLOW** wire:

- once for next pattern (refer to FLASH PATTERNS charts).
- for more than 5 seconds to reset to FP#0.

LIGHTHEAD GROUPING

In Warning Mode, the Lighthouse Groups can be changed by applying **+12VDC** to **YELLOW** wire for 2~4 seconds.

| HG# | HEAD GROUPING |
|-----|---------------|
| 1 | All |
| 2 | Split |
| 3 | Cross |
| 4 | Outside-In |
| 5 | Side-by-Side |

| FP# | FLASH PATTERNS |
|-----|----------------|
| 0 | Single Slow |
| 1 | Single Mid |
| 2 | Single Fast |
| 3 | Double 1 |
| 4 | Double 2 |
| 5 | Quad |
| 6 | Quint |
| 7 | Ultra |
| 8 | Single-Quad |
| 9 | Single H/L |
| 10 | Random |

TAKE DOWNS & ALLEYS

To activate Take Downs and Alleys, apply **+12VDC** to:

- **GREEN** wire for Left-Side Take Down Light
- **PURPLE** wire for Right-Side Take Down Light
- **BLUE** wire for Left-Side Alley Light
- **GRAY** wire for Right-Side Alley Light

NOTE: In Warning Mode, Alleys are automatically off when Take Downs are activated.

VEHICLE ROOF INSTALLATION

STANDARD FEET

Install Mounting Feet on the Lightbar

1. Turn the lightbar upside down.
2. Place mounting feet over the carriage bolts.
3. Attach a lockwasher and a nut on each of the carriage bolts, but do not completely tighten the bolts. Leave them loose enough to reposition the mounting foot.

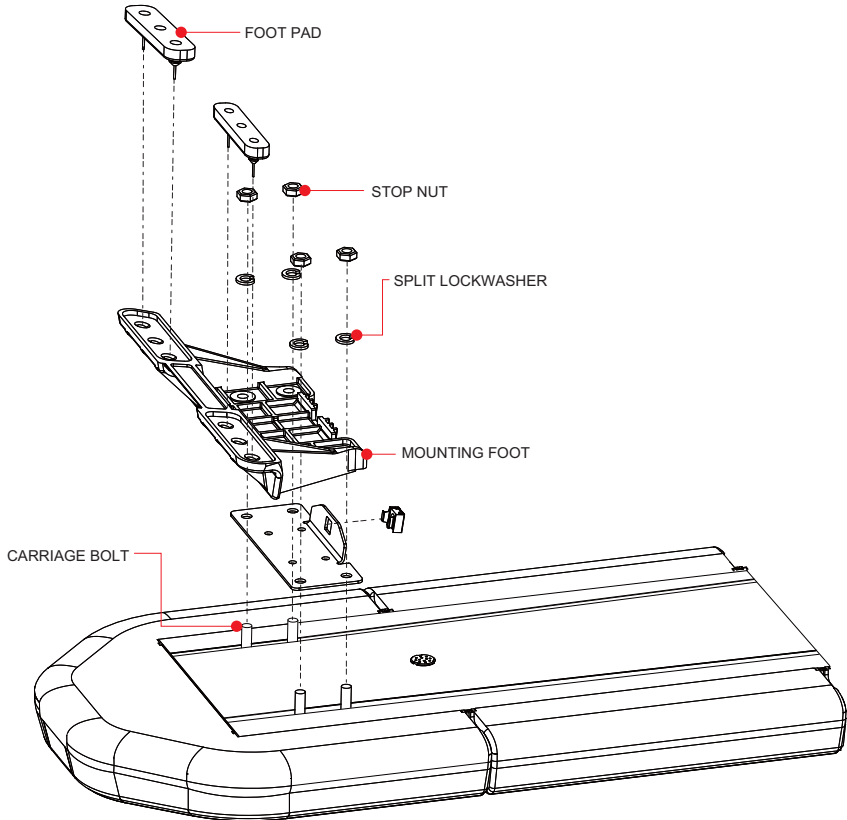

Upside down view of lightbar with mounting foot

ADJUSTABLE FEET

Install Mounting Feet on the Lightbar

1. Turn the lightbar upside down.
2. Place mounting feet over the carriage bolts.
3. Attach a lockwasher and a nut on each of the carriage bolts, but do not completely tighten the bolts. Leave them loose enough to reposition the mounting foot.

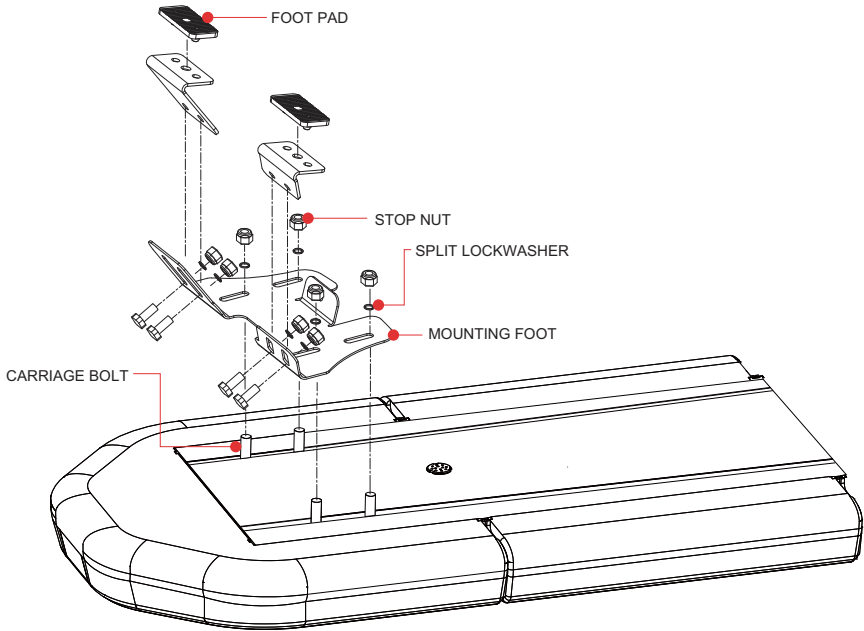

Upside down view of lightbar with mounting foot

PERMANENT MOUNT

Installation includes centering the lightbar on the vehicle's roof, leveling the lightbar, and scribing and drilling holes for mounting the lightbar permanently to the roof.

1. Place lightbar on the vehicle roof at the desired location. The lightbar is usually centered on the door center post (B-pillar).
2. Adjust both mounting feet in or out as necessary until the foot pads rest near the edge of the roof or gutter where the roof is the most rigid. Make sure the lightbar and the mounting feet are centered left to right on the vehicle.
3. Level the lightbar by shifting the lightbar slightly forward or back.
4. Using the mounting feet as a template, mark two drilling holes on each end of the vehicle roof.
5. Carefully remove the lightbar and turn it upside down, and ensure that the mounting feet do not shift place.
6. Tighten the nuts that secure the mounting feet to the lightbar.
7. Drill four holes at the previously marked drilling positions.

WARNING: DO NOT DRILL THROUGH the roof support structure that spans the distance between the driver's and passenger's side. Drilling through this will weaken the roof of the vehicle.

NOTE: Before drilling holes, ensure that the holes will go through sheet metal and not the upholstery. And ensure that no damages are caused to the vehicle components.

8. Place lightbar on the vehicle roof and align the mounting holes with the mounting feet. Secure mounting feet to vehicle roof with carriage bolts.

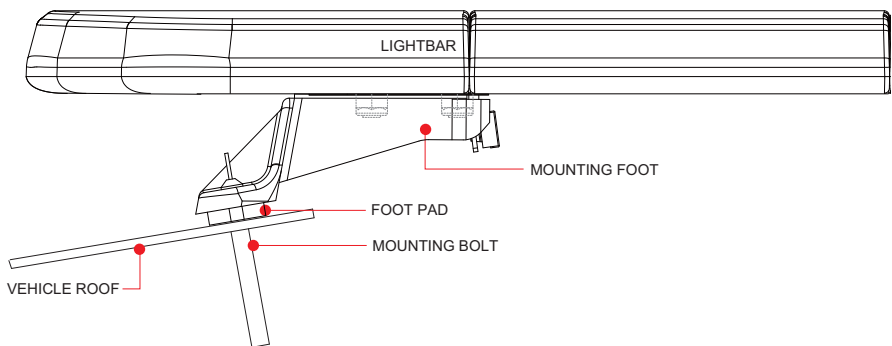

Front view of lightbar with Permanent mount

NOTE: After installation, frequently inspect the lightbar and mounting feet to ensure that all fasteners and brackets are tight.

STRAP KIT MOUNT

The Strap Kit is designed for specific make and mode of vehicle. Before installation, ensure that the correct strap kit is used.

1. Place the lightbar on the vehicle roof at the desired location. Usually, the lightbar should be centered on the center door post (B-pillar).

NOTE: Water may leak into the vehicle interior if the straps are improperly positioned. Ensure that the straps are positioned above or near the center door post (B-pillar).

2. Determine where the straps will attach to the vehicle.

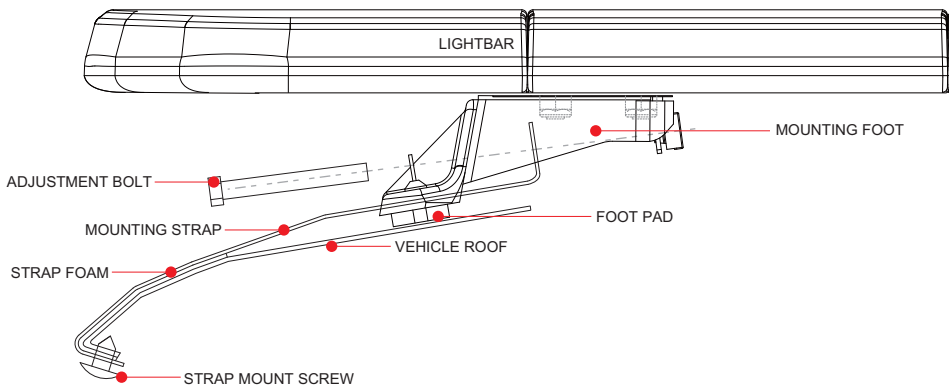

Front view of lightbar with Strap Kit mount

3. Place the straps in position on the roof sheet metal as shown in diagram.
4. Use the straps as a template and mark the drilling hole locations.
5. Drill holes according to the marked locations.
6. Apply a silicone sealant (user-supplier) around the holes before attaching the straps.
7. Secure the straps with the sheet metal screws.

NOTE: After installation, frequently inspect the lightbar and mounting feet to ensure that all fasteners and brackets are tight.

8. Place the lightbar on the vehicle roof, and align strap bolt holes with lightbar mounting feet bolt holes.
9. Insert adjustment bolt through strap bolt hole all the way to mounting feet bolt hole.
10. Tighten bolts.

FLAT SURFACE INSTALLATION

NARROW SURFACE MOUNT

1. Turn the lightbar upside down.
2. Place mounting feet over the carriage bolts.
3. Attach a lockwasher and a nut on each of the carriage bolts, but do not completely tighten the bolts. Leave them loose enough to reposition the mounting foot.

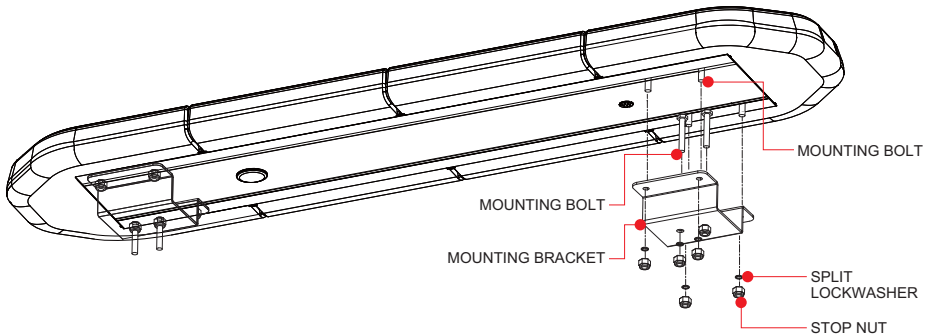

Hardware for Narrow Surface Mount

4. Place lightbar on the mounting surface at the desired location.
5. Adjust both mounting foot assemblies in or out as necessary. If possible, try to keep mounting feet near the ends of the lightbar.
6. Using the mounting feet as a template, mark two drilling holes on each end of the mounting surface.
7. Carefully remove the lightbar and turn it upside down, and ensure that the mounting feet do not shift place.
8. Tighten the nuts that secure the mounting feet to the lightbar.

NOTE: Before drilling holes in ANY part of the vehicle, be sure that both sides of the mounting surface are clear of parts that could be damaged, such as brake lines, fuel lines, electrical wiring, or other vital parts.

9. Drill four holes at the previously marked drilling positions.
10. Place lightbar on the mounting surface and align mounting holes with the mounting feet.
11. Secure mounting feet to mounting surface with carriage bolts.

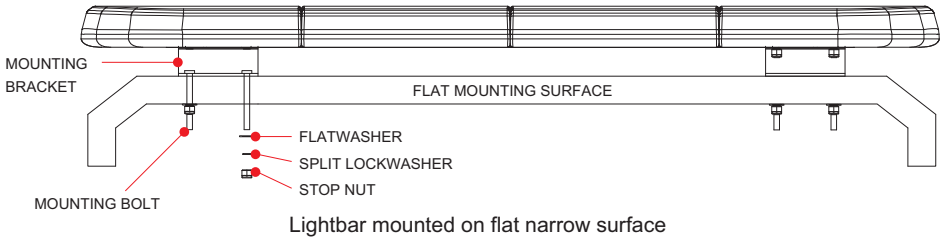

WIDE SURFACE MOUNT

1. Turn the lightbar upside down.
2. Place mounting feet over the carriage bolts.
3. Attach a lockwasher and a nut on each of the carriage bolts, but do not completely tighten the bolts. Leave them loose enough to reposition the mounting foot.

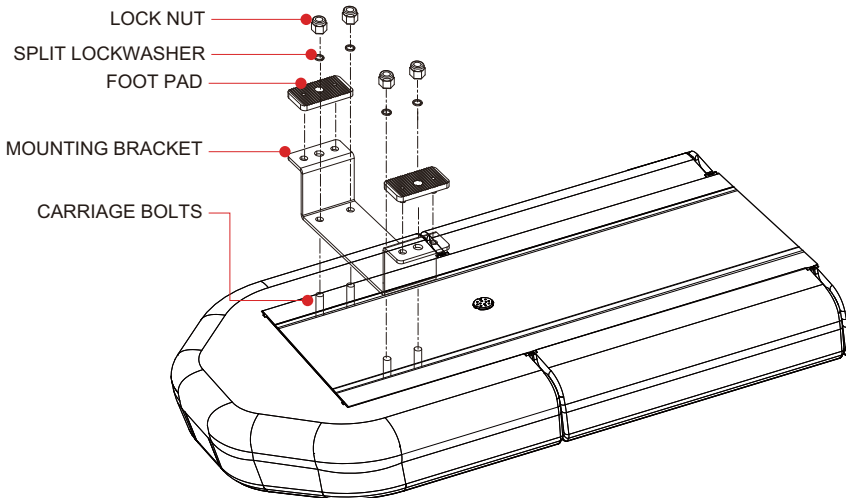

Upside down view of lightbar with mounting foot

4. Place lightbar on the mounting surface at the desired location.
5. Adjust both mounting foot assemblies in or out as necessary. If possible, try to keep mounting feet near the ends of the lightbar.
6. Using the mounting feet as a template, mark two drilling holes on each end of the mounting surface.
7. Carefully remove the lightbar and turn it upside down, and ensure that the mounting feet do not shift place.
8. Tighten the nuts that secure the mounting feet to the lightbar.

NOTE: Before drilling holes in ANY part of the vehicle, be sure that both sides of the mounting surface are clear of parts that could be damaged, such as brake lines, fuel lines, electrical wiring, or other vital parts.

9. Drill four holes at the previously marked drilling positions.
10. Place lightbar on the mounting surface and align the mounting holes with the mounting feet.
11. Secure mounting feet to mounting surface with carriage bolts.

